

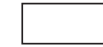

OVERALL LENGTH  
W/INTEGRAL, EXTENDED  
SWIM PLATFORM

**34'6"**  
10.5 M



ARCTIC WHITE



HORIZON GREY



MAHOGANY  
BROWN



MOJAVETAN



ONYX



RALLY RED



SEA RAY BLUE

BEAM	10'6" / 3.2 M
DRY WEIGHT	11,787 LB / 5,347 KG
DRAFT (STERNDRIVES DOWN & UP)	36" / 91 CM & 29" / 74 CM
DEADRISE	21°
HOLDING TANK	27 GAL / 102 L

The specification measurements are approximations and subject to variance.



**160 GAL**  
605 L



**30 GAL**  
113 L



YACHT CERTIFIED

#### SLX 350 FEATURES

- A superior ride & handling is further enhanced with optional Axis<sup>®</sup> Propulsion System w/joystick control and Dynamic Running Surface™
- Revolutionary styling is accentuated by extended hull side windows and luxury-auto style upholstery
- Best-In-Class seating layout includes seating for 18 anchored by ergonomic, convertible aft loungers
- Plenty of Sun coverage via fiberglass hardtop w/optional extended sunshade
- Innovations, such as unique storage solutions throughout the interior and proprietary quietRIDE™ Technology - featuring Tuned Transom<sup>®</sup>, enhance the boater's experience
- Next Wave features include standard Digital Dash w/Chartplotter and optional enhanced lighting package

#### STANDARD PROPULSION

Twin MerCruiser<sup>®</sup> 6.2L MPI ECT  
Bravo<sup>®</sup> III w/DTS Sterndrives  
(T-300 hp - 224 kW)

**Sea Ray**  
LAUNCH INTO LIVING

# SLX<sup>®</sup> 350

## FEATURES & STANDARD EQUIPMENT

### HULL & DECK FEATURES

Cleats, Thru-Bolted - Stainless Steel (8)  
Drain Plug, Brass-Threaded  
Gel Coat, Arctic White  
Graphics, Gel Coated Tapered Boot Stripe  
Hardtop, Fiberglass w/Carbon Fiber Reinforcement & Courtesy Lights  
Lights, Navigation - Stainless Steel w/Motorized Mast Light Resin, High-Performance Vinylester  
Rub Rail, Black PVC w/Stainless Steel Insert  
Ski Tow Eye, Stainless Steel  
Storage, Anchor w/Hatch  
Swim Platform, Integral/Extended; Swim Ladder w/Integral Grab Handle, Dedicated Storage Area for Stern Anchor Thru-Hull Fittings, Stainless Steel  
Vent System, Engine Compartment - Integral w/Stainless Steel Grill  
Windshield, Tempered/Tinted Curved Glass w/Stainless Steel Cap, Walk-Thru & Stainless Steel Supports  
Windshield Wiper - Starboard

### CERTIFICATIONS:

Meets Applicable USCG & ABYC Standards  
NMMA Certification  
Mercury<sup>™</sup> Installation Quality Certification

### COCKPIT FEATURES

Beverage Holders, Stainless w/Rubber Insert  
Carpet Liner, Snap-In  
Cooler, Cockpit w/Dedicated Storage (2)  
Dash, Custom Soft-Touch w/Wood-Grain Accents  
Dash, Acrylic Skylight (Port & Starboard)  
Deck Coaming Entry Access, Port & Starboard Cockpit Door, Bow Block-Off - Acrylic  
Floor, Finished Fiberglass w/Drainage Overboard  
Glove Box, Helm - Lockable  
Grab Handles, Stainless Steel w/Vinyl Wrap  
Hatch, Engine Compartment - Electrically Actuated  
Port Head Compartment:

- Enclosed w/Fiberglass Lockable Door, Molded Fiberglass Liner w/Solid Surface Countertop, Vessel Sink & Pullout Sprayer
- Head (VacuFlush<sup>®</sup>) w/Settee Lid & 27-Gallon Holding Tank
- Wood Storage Cabinet w/Mirrored Door & Light
- Portlight, Skylight
- Storage System

Starboard Helm Compartment:

- Enclosed w/Fiberglass Liner
- Light
- Storage System
- Opening Portlight w/Screen
- CO Monitor

Lighting, Courtesy  
Outlet, 12V Accessory (2)  
Stereo, 12V AM/FM Rockford Fosgate<sup>®</sup>, Wireless Bluetooth<sup>™</sup>, Amplifier, Weatherproof Rockford Fosgate<sup>®</sup> Speakers (8) & Digital Cockpit Remote Control - Helm & Transom  
Storage, Cockpit Side Panel  
Storage, In-Floor w/Gas-Assisted Hatch, Lighting & Vinyl Matting  
Storage, Side Panels - Bow  
Table, Cockpit - Fiberglass  
Vinyl, Marine-Grade w/Mildew & UV Protection  
Walk-Thru Transom  
Wet Bar w/Solid-Surface Countertop, Stainless Steel Sink, Faucet, Refrigerator (2.3 cu. ft.), Stainless Steel Grab Handle, Trash Receptacle & Storage Area Below

### COCKPIT COLOR:

Color Coordinated Vinyls w/Diamond Pattern and Accent Vinyls, Switch Panel & Soft Touch Dash Instrument Panel:

- Sand (Pearl) with Sterling Carpet

### SEATING:

Bow w/Hinged Cushions; Arm Rests & Table Storage Below  
Cockpit L-Shape Lounger w/Opposing Seating  
Loungers, Concealable Aft Facing  
Seat, Dual Bucket - Helm, w/Slider, Flip-Up Thigh-Rise Bolster and Footrest  
Seat, Dual Bucket - Companion, w/Swivel & Slider and Flip-Up Thigh-Rise Bolster

### TECHNICAL FEATURES

#### quietRIDE<sup>™</sup> TECHNOLOGY:

Vibration Dampening Material Laminated Throughout Hull, Deck & Liner for Enhanced Sound Deadening  
Proprietary Tuned Transom<sup>®</sup> by Omni Products, Inc. Reduces Structural Vibration from Engine & Drive  
Acoustical Insulation Strategically Applied for Optimal Sound Absorption  
Strategically Placed Bulkheads Engineered to Block and Absorb Noise  
Engineered Fit & Finish of Components Helps Reduce Unwanted Noise & Vibration

### HELM:

Alarms, Engine - Oil & Water (Audible)  
Alarm, High-Water - Bilge  
Digital Dash Plus W/ Chartplotter  
Compass  
Horn  
SmartCraft Digital Throttle & Shift (DTS) w/Trim Switch & Ignition Cutout Switch (Binnacle Control w/All Engines)  
Steering, Power-Assisted  
Steering, Tilt Wheel  
Switch Panel w/Backlit Push Button Switches  
Tilt & Trim, Power

### ELECTRICAL SYSTEMS:

Battery Switch, Dual  
Battery Trays w/Mounts  
Wiring, Color-Coded w/Chafe Protection

### ENGINE COMPARTMENT:

Bilge Pump, 12V Automatic  
Bilge Pump, 12V Automatic High-Water  
Blowers, 12V Bilge (2)  
Fire Suppression System - Automatic w/Manual Pull  
Gel-Coated Engine Compartment  
Lighting, 12V  
Oil Filter - Remote

### FUEL SYSTEM:

Evaporative Emissions Fuel System  
Fuel Lines, USCG - Type A-1  
Fuel Tank w/Anti-Siphon Valve & Electric Sending Unit

### UNDERWATER GEAR:

Propellers, Stainless Steel  
Variable Running Surface (Trim Tabs)

### WATER SYSTEM:

Pressure Water System w/12V Pump  
Faucet, Wet Bar  
Pullout Sprayer, Head & Transom  
Water Tank (30 Gallons), w/Level Indicator and Water Filter System

### STANDARD PROPULSION

Twin MerCruiser<sup>®</sup> 6.2L MPI ECT<sup>™</sup> Bravo<sup>®</sup> III w/DTS Sterndrives (T-300 hp - 224 kW)  
\*Non-catalyzed engines available for select international markets. Consult your local dealer for availability.

## OPTIONS & ACCESSORIES

### OPTIONAL PROPULSION

#### TWIN GASOLINE STERNDRIVES:

T-MerCruiser 6.2L MPI ECT<sup>™</sup> Bravo III w/DTS (T-350 hp - 261 kW)  
T-MerCruiser 8.2 MAG ECT<sup>™</sup> Bravo III w/DTS (T-380 hp - 283 kW)

\*Non-catalyzed engines available for select international markets. Consult your local dealer for availability.

#### AXIUS<sup>®</sup> PROPULSION:

T-MerCruiser 6.2L MPI ECT<sup>™</sup> Bravo III w/Axius (T-300 hp - 224 kW)  
T-MerCruiser 6.2L MPI ECT<sup>™</sup> Bravo IIIx w/Axius (T-350 hp - 261 kW)

T-MerCruiser 8.2 MAG ECT<sup>™</sup> Bravo III w/Axius (T-380 hp - 283 kW)

Axius Propulsion System Includes SmartCraft VesselView Display & Helm Joystick Control

\*Non-catalyzed engines available for select international markets. Consult your local dealer for availability.

#### DIESEL AXIUS<sup>®</sup> PROPULSION:

T-Mercury<sup>®</sup> Diesel 370 TDI<sup>®</sup> 4.2L T3 Bravo IIIxr w/Axius (T-364 hp - 271 kW)

# SLX<sup>®</sup> 350

## CANVAS OPTIONS

### CANVAS PACKAGE (FOR FIBERGLASS HARDTOP):

Aft Curtain w/Bungee Straps  
Front Curtains  
Side Curtains  
Canvas Storage Bag

### INDIVIDUAL CANVAS OPTIONS:

Black, Toast Tweed or Marine Midnight Blue Canvas  
Aft Extended Sunshade  
Bow Shade System (Black Only)  
Cockpit & Tonneau Covers w/Canvas Storage Bag  
Mooring Cover (Black Only)  
Retractable (Opening) Canvas Insert for Hardtop

## OPTIONAL PACKAGES

### SHORE POWER:

120V/60 Cycle - 30 Amp Service w/Inlet, 50' Cord & Adapter,  
20A/12V Battery Charger/Converter, Galvanic Isolator &  
Main Distribution Panel (Also Available in 220V/50 Cycle)

### SMARTCRAFT VESSEL VIEW DISPLAY:

(Standard w/Axius Propulsion)  
- Includes: Air & Water Temperature, Combined Fuel Flow/  
Range, Depth, Engine Alarms/Hour Meters, Engine  
Synchronizer, GPS Interface & System Maintenance  
Records, ECO-Screen, Smart Tow™ and Troll Control™

### INTERIOR COLOR OPTION:

Espresso (Beige) w/Country Beige Carpet

## INDIVIDUAL OPTIONS

Active Trim w/ Mercury Marine®  
Air Compressor for Water Toys  
Air Conditioning For Helm Berth (Requires Inverter & Shore  
Power Options)  
Battery Charger  
Berth Upgrade: Cushions; iPod/iPad Connectivity &  
Integration Systems; TV  
Chartplotter - Raymarine® 12" Display Upgrade  
Docking Lights  
Dynamic Running Surface™  
Exhaust, Selectable, Thru-Hull (N/A w/CE Option)  
Fender Clip System - Quick Disconnect  
Filler Cushions, Bow w/Integrated Cushion Storage  
Filler Cushions, Cockpit  
Flagpole w/Base & US Flag  
Flooring, Infinity Seagrass™ - Cockpit  
Flooring, Teak - Cockpit & Deck Entrance Steps  
Flooring, Teak - Swim Platform & Walkthru  
Flooring, Teak - Optional Submersible Swim Platform

Gel Coat, Two-Tone Hullside Color w/White Bottom (Onyx,  
Sea Ray Blue, Rally Red, Mahogany Brown, Horizon Grey or  
Mojave Tan)

Gel Coat, Three-Tone w/ Optional Gel Stripe (Onyx, Sea Ray  
Blue, Rally Red, Mahogany Brown, Horizon Grey or Mojave  
Tan)

Gel Coat, Hull Bottom Color (Onyx)

Gray Water System

Grill, Wet Bar, Electric (Requires Inverter & Shore Power  
Options)

Head, System VacuFlush® w/Direct Overboard Discharge  
(Int'l)

Hot Air Vents, Cockpit

Inverter (12VDC to 120VAC)

Ladder, Bow w/Hatch

Lighting, Enhanced Blue or White LED Package,  
(Exterior and Cockpit)

Lighting, Thru Hull Underwater

Macerator w/Seacock Interlock System

SiriusXM® Satellite Receiver w/Antenna (N/A Outside N.  
America)

Spotlight, 5" Remote-Controlled  
Stereo, Premier Audio Upgrade w/Rockford Fosgate®  
Components: Amplifier & Subwoofer

Swim Platform, Automated Submersible

Table, Bow Fiberglass

Table, Bow w/Teak Overlay

Table, Cockpit, Fiberglass w/Teak Overlay (Replaces Standard  
Fiberglass)

Table, Cockpit, Fiberglass - Hydraulically Actuated  
(Retractable to Flush Mount w/Floor)

Table, Cockpit, Fiberglass w/Teak Overlay - Hydraulically  
Actuated (Retractable to Flush Mount w/Floor)

VHF Radio w/3.5' Stainless-Steel Antenna & Stainless-Steel  
Ratchet Mount

Water Heater (6 gallon)

Windlass, Thru-Hull Rope/Chain w/Galvanized Anchor; Wash  
Down and Bow Controls

Windlass, Thru-Hull All Chain w/Galvanized Anchor; Wash  
Down and Bow Controls

Windlass, Thru-Hull Rope/Chain w/Stainless Steel Anchor;  
Wash Down and Bow Controls

Windlass, Thru-Hull All Chain w/Stainless Steel Anchor;  
Wash Down and Bow Controls

CE Option

### TRAILER OPTIONS:

Int'l Trailer, Aluminum w/Bunks

Int'l Trailer, Aluminum w/Rollers

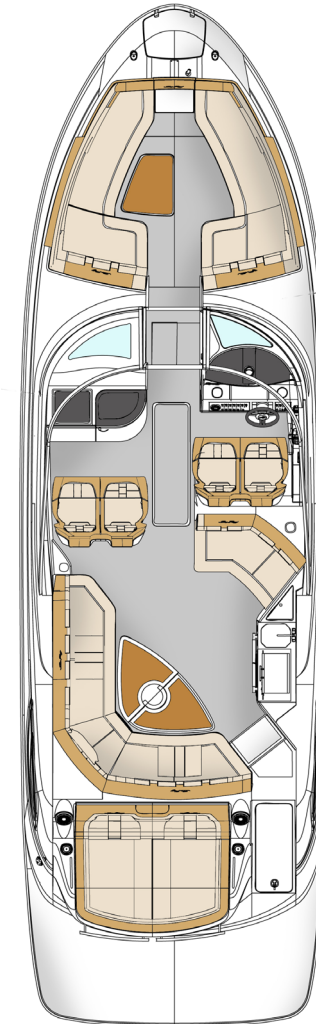

### Standard Seating Plan

Bow Rider, Hinged Cushions w/Arm Rests &  
Table Storage Below,  
Cockpit L-Shape Lounger w/Opposing Seating  
Loungers, Concealable Aft-Facing;  
Seat; Dual Bucket - Helm, w/Slider,  
Flip-Up Thigh-Rise Bolster and Footrest;  
Seat; Dual Bucket - Companion, w/Swivel & Slider  
and Flip-Up Thigh-Rise Bolster



# SLX<sup>®</sup> 350

Stay out longer. Invite more friends along. Turn the journey into the destination. The Sea Ray SLX 350 redefines “day boat” to mean all day and then some. Comfortable seating for 18 passengers underway means connecting with friends, family, even generations. An array of Sea Ray’s Next Wave™ innovations provide a superior experience, from the noise-quashing powers of Quiet Ride™, to the precision and stability of Dynamic Running Surface, to the agility of Axis® joystick technology. And a host of intelligent features combine in a sleek, stylish package that far surpasses the typical bowrider. Bow to stern, the SLX 350 is designed to ensure that all day unfolds your way.



11122016

Sea Ray Boats, 800 S. Gay Street, Suite 1200, Knoxville, TN 37929. Internet address: <http://www.searay.com>  
Note: Not all accessories shown in pictures or described herein are standard equipment or even available as options. Some features and options may not be available when a boat is built for outside North America and/or has CE Certification. Options and features are subject to change without notice. Not all model year boats may contain all the features or meet the specifications described herein. Confirm availability of all accessories and equipment with an authorized Sea Ray dealer prior to purchase. Printed in the U.S.A. November 2016 ©Sea Ray Boats.