

450 SUNDANCER®



OVERALL LENGTH
W/EXTENDED
SWIM PLATFORM

45'5"
13.84 M

○ ARCTIC WHITE ● BLACK ● BLUE ● HORIZON ● PATINA

BEAM	13'2" / 4.01 M
DRY WEIGHT (AXIUS)	24,362 LB / 11,050 KG
DRAFT (AXIUS DOWN & UP)	38" / 97 CM & 32" / 81 CM
DRAFT (ZEUS)	46" / 117 CM
DEADRISE	19°
HOLDING TANK	42 GAL / 159 L

The specification measurements are approximations and subject to variance.



300 GAL
1,135 L



70 GAL
265 L



6
PEOPLE

450 SUNDANCER FEATURES

- ≈ Axius propulsion includes Skyhook® station-keeping technology
- ≈ Media room with theater seating and flatscreen TV
- ≈ Standard Raymarine® e125 Widescreen Radar/Chartplotter combo
- ≈ Stereo with Wireless Bluetooth™ and media inputs
- ≈ Standard generator with sound shield
- ≈ Optional Zeus® propulsion with helm joystick

STANDARD PROPULSION

Twin MerCruiser® 8.2 MAG
Axius® Propulsion w/Bravo® IIIx
(T-380 php - 283 kW)

Sea Ray®
LAUNCH INTO LIVING

450 SUNDANCER®

FEATURES & STANDARD EQUIPMENT

HULL & DECK FEATURES

Bottom Paint
Bow Rail, 316 Stainless Steel w/Welded Stanchions, Intermediate Rails & Life Lines
Cleats, Thru-Bolted - Stainless Steel (8)
Deck Fill Plates, Stainless Steel
Deck Rails, 316 Stainless Steel
Drain Plug, Brass-Threaded - Garboard
Gel Coat - Arctic White
Graphics, Striping
Graphics, Transom Numerator
Handrails, 316 Stainless Steel
Hatch, Deck Vent - Translucent w/Locks & Sky Screen Covers (Trapezoid)
Hull Windows, Molded Acrylic
Lights, Navigation
Resin, High-Performance Vinyl Ester
Rub Rail, PVC w/Stainless-Steel Insert
Storage, Transom (For Fenders & Gear) w/Gas Assist
Stringer System, Foam & Fiberglass
Swim Platform w/Concealed Stainless-Steel Four-Step
Swim Ladder w/Integral Grab Handle
Thru-Hull Fittings, Stainless Steel
Toe Rail, Molded Fiberglass - Deck
Vent System, Engine Room, Stainless Steel
Windshield, Tempered/Tinted Curved Glass Bonded In w/ Electric Front Vent
Windshield Washer System
Windshield Wipers w/Delay & Speed Control

CANVAS (SUNBRELLA®)

Canvas Colors - Blue, Black or Taupe
Aft Curtain w/Bungee Cords

CERTIFICATIONS:

Meets Applicable USCG & ABYC Standards
Mercury Installation Quality Certification (Gas Engines)
NMMA Certification

MOORING SYSTEM:

Anchor, Galvanized
Anchor Chute, Stainless Steel
Anchor Rope/Chain Storage w/Gas-Assisted Hatch
Windlass, Rope/Chain w/Foot Switches

COCKPIT FEATURES

Beverage Holders
Cooler, Carry-On w/Designated Storage
Door, Cabin Entry (Sliding & Lockable) w/Skylight
Door, Transom w/Stainless-Steel Frame & Arctic Insert
Floor Liner, Fiberglass - Self-Bailing
Handrails, 316 Stainless Steel
Hardtop, Fiberglass w/Retractable Sunroof, Overhead Lighting
Hatch, Engine Room - Electrically Actuated
Ice Bucket, Insulated - Built-In
Icemaker, 120V
Lighting, LED - White
Outlet, 12V Accessory

Outlet, 120V GFI Protected
Rod Holders (2)
Seating, Double-Wide Helm w/Flip-Up Thigh-Rise Bolster, Armrests, Heavy-Duty Pedestal w/Slide & Pneumatic Vertical Adjustment
Seating, Port Double-Wide w/Flip-Up Thigh-Rise Bolster, Armrest & Fiberglass Storage Base
Seating, Aft - U-Shaped w/Storage Below
Steps, Molded - Deck Access
Storage, Side Panel - Port & Starboard
Sun Pad, Cockpit w/Storage Below
Table, Cockpit - Fiberglass w/Dedicated Storage
Wet Bar w/Sink, Faucet, Solid-Surface Countertop, Stainless-Steel Handrail, Trash Receptacle & Storage Cabinet - Starboard

CABIN FEATURES

Carbon Monoxide Monitors
Carpet, 55-Ounce, 100% Stainmaster® BCF Nylon w/ Dupont® Advanced Teflon Repel System
Curtains & Drape Trim
Flooring, Carpet
Handrails, Stainless Steel
Lighting, White - LED
Outlet & Switch Plates - Polished Chrome Finish
Outlets, 12V Accessory
Outlets, 120V GFI Protected
Pillows, Accent
Steps, Entryway - Wood w/Stainless-Steel Handrail

INTERIOR FINISHES & TREATMENTS:

Wood Cabinetry: Walnut
Window Treatment: Silver Alloy Blinds
Carpet: Dark or Light

SALON:

Seating, L-Shaped Sofa w/Storage Below - Converts to Bed w/Filler Cushions
Stereo, iPod® Interface Port w/Docking Station
Stereo, 12V AM/FM, Wireless Bluetooth™, SiriusXM®
Satellite Receiver w/Antenna, Amplifier, Subwoofer, Speakers (4 cabin, 4 cockpit), Digital Cockpit Remote Control & Speaker Selector Switches
Storage, Gunwale Cabinets
Storage, In-Floor
Table, Wood - Dinette w/Dedicated Storage

GALLEY:

Coffeemaker, Keurig®
Countertop, Solid Surface w/Sink, Faucet & Sink Cover
Handrail, Stainless Steel
Microwave w/Stainless-Steel Front - 120V
Power Vent, 12V w/Stainless-Steel Grill
Refrigerator/Freezer w/Stainless-Steel Front - Dual Voltage
Storage, Drawers w/Cutlery Insert
Storage, Upper & Lower w/Designated Plate & Glass Storage
Stove, Two-Burner (Recessed) w/Solid-Surface Cover - 120V
Trash Receptacle

FORWARD STATEROOM:

Bed, Full-Size Island-Style w/Mattress, Electrically Actuated
Extension & Posturepedic® Backrest w/Visco Elastic Foam Mattress & Drawer Storage Below
Decorative Rope Locker Bulkhead w/Accent Lighting
Door, Privacy - Handcrafted Solid Wood w/Translucent Screens
Flooring, Carpet
Linens - Pillows, Sheets & Coordinated Spread
Lighting, Task - 12V, Port & Starboard
Storage, Gunwale Cabinets - Port & Starboard
Storage, Hanging Lockers (2) - Port & Starboard
TV, 24" LED w/remote Blu-ray™ Player

FORWARD HEAD (STARBOARD):

Door, Access from Forward Stateroom & Salon
Floors, Tile
Handrails, Stainless-Steel
Head, VacuFlush®
Power Vent, 12V w/Stainless-Steel Grill
Robe Hook
Storage Drawers
Storage, Gunwale Cabinet - Mirrored
Towel Bar
Towels - Sea Ray
Vanity w/Solid-Surface Countertop, Sink, Faucet & Storage Below

FORWARD SHOWER (PORT):

Curtain, Shower
Door, Access from Forward Stateroom
Floors, Tile
Handrails, Stainless Steel
Robe Hook
Shower w/Seat, Adjustable Shower Wand & Dedicated Shampoo Bottle Storage
Storage, Gunwale Cabinet

MID STATEROOM / MEDIA ROOM:

Curtain, Privacy w/Dedicated Storage
Entertainment System:
- TV, 50" LED / Smart w/Remote Blu-ray™ Player
- Surround Sound Audio (1 TV, Stereo)
- Audio/DVD Player (Media Room)
Hanging Locker w/Light - Port & Starboard
Lighting, Blue LED Accent
Ottomans, (2) Movable w/Dual-Purpose Tops (Cushions or Cocktail Tables) & Storage Below
Seating, Conversation Pit - Converts to Double Berth w/ Slide-Out Base
Storage, Cabinet - Starboard

TECHNICAL FEATURES

AIR CONDITIONING/HEATING:

Cabin, Zone-Controlled Reverse-Cycle System (24,000 BTU)
Custom Integral Vent System

CONTROL STATION:

Alarms, High-Water - Bilge & Cabin
Battery Parallel Switch - Engines
Compass
Dash, Gel Coated
Horns, Air (Concealed) - Dual Trumpet
Instrument Panel, High-Gloss
Joystick Control, Axis® or Optional Zeus®
Power Steering, Hydraulic w/Tilt Wheel
SmartCraft® Digital Throttle & Shift Controls (DTS)
SmartCraft® Diagnostics:
- Instrumentation, Custom Sea Ray® SmartCraft w/Low-Glare Blue Night Lighting & Chrome Bezels
- 4-in-1 Multigauges (2) (Includes: Fuel Level, Oil Pressure, Voltmeter & Water Temperature)
- Tachometers (2)
SmartCraft VesselView Display:
- Propulsion: Engine Hour Meters, Engine Status, Performance & Fuel, Peak Performance, Boost Pressure (Optional), Troll Control & Cruise Control
- Vessel: Vessel Status, Tank Status, Steering Position & Generator Data

ELECTRICAL SYSTEMS:

Batteries w/Trays (4)
Battery Charger/Converter, 120V/40 Amp/12V
Battery Switches, 2-Way Solenoid Activated (MDP & Bilge)
Cable TV System w/Inlet, TV Shore Cord, Coax Outlets, Gain Control & Omni Directional Antenna
Galvanic Isolators (2)
Shore Power Transformer, 240V/50 Amp/60 Cycle/12Kva
Panel, DC Circuit Breaker - Remote
Panel, DC Main Breaker
Panel, Main Distribution - AC
Panel, Main Distribution - DC
Shore Power, CableMaster™, 240V/50 Amp/60 Cycle w/75' Cord
Wiring, Color-Coded w/Chafe Protection

ELECTRONICS:

Autopilot, Integrated w/Axis or Optional Zeus System
Electronics Circuit, 12V/50 Amp
Raymarine® e125 Widescreen 12.1" Color LCD, Radar/GPS/Chartplotter w/Integrated 4-kW HD Open Array Scanner
VHF Radio w/Remote Speaker & 8' Fiberglass Antenna

ENGINE ROOM:

Bilge Pumps, 12V Automatic (2)
Bilge Pumps, 12V Automatic High-Water (1 Bilge, 1 Cabin)
Blowers, 12V Bilge (2)
Fire Suppression System - Automatic w/Manual Pull
Gel-Coated Engine Room
Ladder, Stainless Steel - Removable
Lighting, 12V - Engine Room

450 SUNDANCER®

FUEL SYSTEM:

Fuel Filters, Remote (Racor® Filters for Diesel Engines)
 Fuel Lines, USCG - Type A-1
 Fuel Tanks, Aluminum w/Electric Shutoff Valves (Manual Valves for Diesel) & Ultrasonic Sending Units
 Fuel Transfer Pump, Electric (Available Only w/Diesel Engines)

GENERATOR:

10 kW Kohler® Low CO - Gas, 120V/60 Cycle w/Sound Shield, Remote Start, Muffler, Closed Cooling, Seacock & Seawater Strainer & SmartCraft® Interfacing

UNDERWATER GEAR:

Propellers, Stainless Steel
 Seacocks (On All Underwater Fittings)
 Seawater Strainers
 Trim Tabs, Hydraulic (Integrated w/ Zeus® System When Selected)

WASTE SYSTEM:

Head System, VacuFlush®
 Holding Tank Level Indicators - MDP
 Holding Tank w/Dockside Pump-Out
 Sump Box w/Pump - Automatic

WATER SYSTEM:

Freshwater Washdown Spigots - Transom & Engine Room
 Manifold System w/Shutoff Valves
 Pressure Water System w/12V Pump & Charcoal Filtration System
 Shower, Cockpit - Hot & Cold
 Water Heater, 120V (11 Gallon)
 Water Inlet, Dockside

STANDARD PROPULSION

TWIN GASOLINE AXIUS® PROPULSION:

T-MerCruiser 8.2 MAG ECT* Bravo IIIx w/Axius (T-380 hp - 283 kW)

*Non-catalyzed engines available for select international markets. Consult your local dealer for availability.

OPTIONS & ACCESSORIES

OPTIONAL PROPULSION

TWIN GASOLINE AXIUS PROPULSION:

T-MerCruiser 8.2 MAG ECT* SeaCore™ Bravo IIIx w/Axius (T-380 hp - 283 kW)

T-MerCruiser 8.2 MAG HO ECT* Bravo IIIx w/Axius (T-425 hp - 317 kW)

T-MerCruiser 8.2 MAG HO ECT* SeaCore Bravo IIIx w/Axius (T-425 hp - 317 kW)

*Non-catalyzed engines available for select international markets. Consult your local dealer for availability.

TWIN DIESEL ZEUS® DRIVES:

T-Zeus-Cummins® QSB 6.7 - 425 HO (T-407 hp - 303 kW)

ELECTRONICS OPTIONS

Raymarine® CP 300 Fishfinder Module (For e125 Display)
 Raymarine e125 Widescreen, GPS/Chartplotter - Auxiliary Display

INDIVIDUAL OPTIONS

Air Conditioning/Heating - Cockpit (16,000 BTU) w/Defroster
 Anchor, Stainless Steel (In Lieu of Galvanized)
 Canvas, Cockpit Drop Curtain & Aft Seat Cover
 Canvas, Dash Cover
 Carpet Runners, Interior (Sunbrella)
 Cockpit Carpet Liner
 Colored Hull (Black, Blue, Horizon or Patina)
 Cockpit Side Windows - Electric, Opening
 Doors, Dual Sliding Handcrafted Solid Wood w/Translucent Screens - Lower Salon (In Lieu of Standard Curtain)
 Digital Satellite System (DSS TV)
 Flooring, Teak - Upper Cockpit
 Flooring, Teak - Lower Cockpit
 Flooring, Teak - Swim Platform
 Flooring, Wood - Salon & Galley
 Footrest, Helm Seat - Stainless Steel
 Grey Water System
 Grill, Built-In w/Fiberglass Lid (120V) - Cockpit
 Hull Windows, Opening (1 Salon, 1 Galley)

Interior Treatment: Wood Cabinetry Finishes - High Gloss Cherry (Light or Dark)

Interior Treatment: Wood Blinds - Light Cherry, Dark Cherry or Walnut

Interior Treatment: Roman Shades

Lighting, Underwater - Transom (2)

Macerator w/Seacock Interlock System

Oil Changer System - Engines & Generator

Passerelle System - Transom

Portlights, Opening (2 Mid-Stateroom) - Stainless Steel

Portlights, Opening (2 Salon & Galley) - Stainless Steel

Refrigerator, Dual Voltage - Cockpit (Drawer-Style In Lieu of Std IceMaker)

Remote Control, Universal - Logitech Harmony

Spotlight w/Dual Halogen Bulbs - Remote Controlled

Stereo, Sound System Upgrade - Cockpit (Speakers & Amps)

Sun Pad, Forward Deck w/Adjustable Backrest

Sunroof Shade, Hardtop

Table, High-Gloss Teak w/Vinyl Cover - Cockpit (In Lieu of Std Table)

Table, Oversized Teak Table Option - Cockpit

TV, 24" LED, w/Remote Blu-ray™ Player - Upper Salon

TV, 24" LED, w/Remote Blu-ray™ Player - Cockpit

Vacuum System, Central - 120V (Beam®)

Windlass, All Chain (In Lieu of Std Rope/Chain)

Windlass Capstan

Windshield Shades

Yacht Flag & Flagpole

CE Option

NOTE: Some features and options may not be available when a boat is built for regions outside North America and/or has CE Certification. Boats ordered with 220V/50 cycle electrical systems will have the appropriate appliances in the corresponding voltage.



COCKPIT LAYOUT

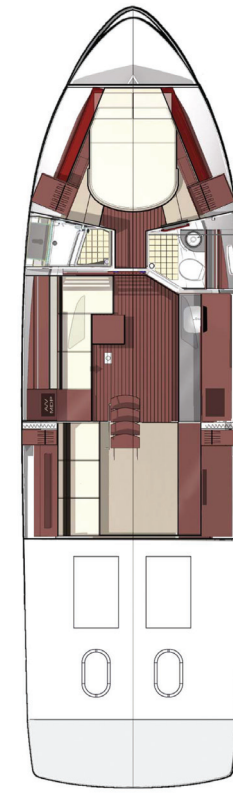

CABIN LAYOUT

450 SUNDANCER®

Aesthetically, the 450 carries forward the cutting-edge design cues created in the latest Sundancer generation - including crisp, clean lines and an enclosed bridge with large, retractable sunroof - while also incorporating all the key features that have taken our express cruisers to the next level. Revolutionary Axisus® propulsion is standard; Zeus® pod drives are optional.



Tiered, instrument panels provide loads of space for the SmartCraft® diagnostic instruments and VesselView display, as well as illuminated rockers and Raymarine® e125 Radar/Chartplotter combo display.



Highlights in the cockpit include a huge, U-shaped lounge with an aft backrest that opens to expand the sun pad. Opposite lies a full wet bar with icemaker and optional barbecue grill and TV.



The streamlined galley has everything an onboard chef needs for quick and efficient meals, including a large countertop, two-burner stove, microwave, refrigerator/freezer, and exceptional storage.



A mid-berth "media room" features accent lighting and an entertainment system with standard 50" flatscreen TV and stereo surround sound audio system. Comfortable seating here converts to a double berth.



Under the sleek exterior of the 450 Sundancer lies a free-flowing interior that makes the boat seem much larger than its dimensions and elevates its "star power."



When it's time to call it a night, the sumptuous master stateroom awaits. Sink into the full-size island berth with Visco memory foam mattress and unwind while watching the 24" flatscreen TV.

