



OVERALL LENGTH
W/INTEGRAL
SWIM PLATFORM

33'4"
10.16 M

OVERALL LENGTH
W/OPT EXTENDED
SWIM PLATFORM

35'8"
10.87 M

○ ARCTIC WHITE ● ONYX ● HORIZON GREY ● SEARAY BLUE ● MAHOGANY BROWN

BEAM *10'5" / 3.18 M*

DRY WEIGHT *13,334 LB / 6,048 KG*

DRAFT (STERNDIVES DOWN & UP) *35"/89 CM & 28"/71 CM*

DRAFT (INBOARDS) *35"/89 CM*

DEADRISE *21°*

HOLDING TANK *28 GAL / 106 L*

The specification measurements are approximations and subject to variance.



200 GAL
757 L



35 GAL
132 L



6
PEOPLE

330 SUNDANCER FEATURES

- ≈ Sleeps up to six
- ≈ Luxurious, comfortable seating with diamond stitch quilted accents
- ≈ Enclosed fiberglass head with VacuFlush® toilet
- ≈ Standard fiberglass sport spoiler
- ≈ Stereo with Wireless Bluetooth™ and media inputs
- ≈ SmartCraft® diagnostic instrumentation with glass lenses
- ≈ Standard Digital Throttle & Shift
- ≈ Optional Axis® propulsion with helm joystick

STANDARD PROPULSION

Twin MerCruiser® 6.2L MPI ECT
Bravo® III w/DTS Sterndrives
(T-300 hp - 224 kW)

Sea Ray
LAUNCH INTO LIVING

330 SUNDANCER®

FEATURES & STANDARD EQUIPMENT

HULL & DECK FEATURES

Anchor Chute w/Hawse Pipe - Concealed w/Hatch Bottom Paint
Bow & Stern Eyes, Stainless Steel
Bow Rail, Stainless Steel w/Welded Stanchions
Cleats, 10" Thru-Bolted, Stainless Steel, w/Sea Ray Logo (8)
Deck Fill Plates, Stainless Steel
Drain Plug, Brass-Threaded - Garboard
Gel Coat, Arctic White
Handrails, Stainless Steel - Transom (2)
Hatch, Deck Vent - Translucent w/Locks & Sky Screen Cover
Hull Windows, Extra Large Acrylic - Fixed (2)
Lights, Navigation - Stainless Steel
Rub Rail, PVC w/Stainless Steel Insert
Skylights (2)
Storage, Transom Wall - For Fenders & Gear
Swim Platform, Integral/Extended w/Concealed Stainless Steel Four-Step Swim Ladder
Thru-Hull Fittings, Stainless Steel
Vent System, Engine Room - Integral
Windshield, Tempered/Tinted Curved Glass w/Walk-Thru & Stainless Steel Supports
Windshield Wipers

CANVAS (SUNBRELLA® - BLACK):

Aft Curtain w/Bungee Straps
Aft Sunshade - Fixed w/Stainless Steel Framing
Canvas Storage Bag
Dash Cover
Front & Side Curtains

CERTIFICATIONS:

Meets Applicable USCG & ABYC Standards
NMMA Certification
Mercury® Installation Quality Certification

COCKPIT FEATURES

Beverage Holders
Carpet Liner, Snap-In
Cockpit Color Package: Mocha or Wheat
Cooler, Carry-On w/Designated Storage
Door, Cabin Entry (Sliding & Lockable) - Fiberglass w/ Integral Steps
Door, Transom - Acrylic w/Stainless Steel Frame
Floor Liner, Fiberglass - Self-Bailing
Hatch, Emergency Pull Handle & Prop Rod
Hatch, Engine Room - Electrically Actuated
Lighting, Indirect
Outlet, 12V Accessory
Outlet, 120V GFI Protected

Seating, Aft-Facing Bench w/Built-In Table Storage & Fiberglass Storage Base
Seating, Fwd-Facing w/Molded Fiberglass Storage Base
Seating, Helm Bench w/Dual Flip-Up Thigh-Rise Bolsters, Adjustable Captain's Seat & Fiberglass Storage Base
Sport Spoiler, Molded Fiberglass (Seamless) w/Overhead Lighting
Steps, Boarding - Molded-In
Storage, Side Panel - Helm
Table, Cockpit - Solid Teak w/Dedicated Storage & Sun Pad Filler Cushions
Wet Bar w/Stainless Steel Sink, Faucet, Beverage Holders, Stainless Steel Handrail, Solid-Surface Countertop & Storage Below

CABIN FEATURES

Carbon Monoxide Monitor
Flooring, Hardwood
Lighting, 12V
Outlets, 120V GFI Protected
Pillows, Accent
Stereo, 12V AM/FM, Wireless Bluetooth™ w/iPod® Connector, Amplifier, Speakers (6) & Digital Cockpit Remote Control
Wood Interior Package - Chestnut (Std), Cherry or Pecan Finished Cabinetry

GALLEY:

Countertop, Solid Surface w/Stainless Steel Sink & Faucet
Handrail, Stainless Steel
Lighting, 12V
Microwave, 120V/60 Cycle
Outlet, 12V Accessory
Power Vent, 12V
Refrigerator, Dual-Voltage - 120V/12V
Storage, Drawers w/Cutlery Insert
Storage, Upper & Lower
Stove, 120V Recessed Two Burner w/Solid-Surface Cover w/ Dedicated Storage
Trash Receptacle

HEAD:

Flooring - Simulated Teak
Handrail, Stainless Steel
Head (VacuFlush®)
Head, Enclosed - Full Fiberglass w/Shower & Curtain
Mirror, Head Door - Full Length
Mirror, Head Wall
Power Vent, 12V
Storage, Medicine Cabinet
Storage, Upper Shelves w/Stainless Steel Rails
Vanity w/Sink, Solid-Surface Countertop, Faucet w/Pullout Sprayer & Storage Below

MID-BERTH

Curtain, Privacy (Hideaway)
Mirrored Bulkhead
Seating, Conversation Pit - Converts to Double Berth w/ Slide-Out Base & Dedicated Filler Cushion Storage
Storage, Drawer
Storage, Upper & Lower

SALON:

Lighting, 12V
Seating, Allante Fabric Sofa - Converts to Bed
Storage, Gunwale Cabinets
Table, Dinette - Solid Wood w/Dedicated Storage

V-BERTH:

Berth, Double w/Visco Elastic Foam Mattress & Storage Below
Curtain, Privacy (Hideaway)
Mirrored Rope Locker Bulkhead
Sheet Set - Fitted (Neutral Color)
Storage Cabinet w/Shelves - Starboard
Storage, Gunwale Storage, Hanging Locker - Port

TECHNICAL FEATURES

HELM:

Alarms, High-Water - Bilge & Cabin
Compass
Emergency Start System - Engines
Horn
SmartCraft® Diagnostics:

- Instrumentation, Custom Sea Ray SmartCraft 4-in-1 Multi-gauges (2) w/Glass Lenses, Low-Glare Blue Night Lighting & Chrome Bezels (Includes: Fuel Level, Oil Pressure, Voltmeter & Water Temperature)
- SmartCraft System Speedometer (Includes: Air & Water Temperature, Combined Fuel Level Range & GPS Interface)
- SmartCraft System Tachometers (2) (Includes: Depth, Engine Alarms/Hour Meters, Fuel Consumption/ Usage & Trim Level)

SmartCraft Digital Throttle & Shift (DTS)
Steering, Power-Assisted
Steering, Tilt Wheel
Switch Pads, Illuminated Weatherproof Electronic w/ISO Symbols & Dimmer Control
Tilt & Trim, Power

ELECTRICAL SYSTEMS:

Battery Charger/Converter, 120V/60 Cycle
Battery Switches (2)
Battery Trays w/Mounts
Breaker Panels, Waterproof - Electronic Interface Modules & Dash Dimmer (Helm & Engine Room)
Isolator, Galvanic

Panel, DC Main Breaker
Panel, Main Distribution - AC
Panel, Main Distribution - DC
Shore Power, 120V/30 Amp w/50' Cord & Adapter
Wiring, Color Coded w/Chafe Protection

ELECTRONICS:

VHF Radio w/8' Fiberglass Antenna & Stainless Steel Ratchet Mount

ENGINE ROOM:

Bilge Pump, 12V Automatic
Bilge Pumps, 12V Automatic High-Water (1 Bilge, 1 Cabin)
Blowers, 12V Bilge (2)
Fire Suppression System - Automatic w/Manual Pull
Insulated & Gel-Coated Engine Room
Lighting, 12V
Oil Filters - Remote

FUEL SYSTEM:

Evaporative Emissions Fuel System
Fuel Lines, USCG - Type A-1
Fuel Tanks, Aluminum w/Electric Shutoff Valves & Mechanical Sending Units

UNDERWATER GEAR:

Propellers, Stainless Steel
Trim Tabs, Hydraulic

WASTE SYSTEM:

Head System (VacuFlush®)
Holding Tank Level Indicator - MDP
Holding Tank w/Dockside Pump-Out (28 Gallon)
Sump Box w/Pump - Automatic

WATER SYSTEM:

Freshwater Washdown Spigot
Pressure Water System w/12V Pump
Shower, Cockpit - Hot & Cold
Water Heater, 120V (6 Gallon) w/Exchanger
Water Inlet, Dockside
Water Manifold System
Water Tank (35 Gallon)

STANDARD PROPULSION

T-MerCruiser® 6.2L MPI ECT* Bravo® III w/DTS (T-300 hp - 224 kW)

*Non-catalyzed engines available for select international markets. Consult your local dealer for availability.

330 SUNDANCER®

OPTIONS & ACCESSORIES

OPTIONAL PROPULSION

TWIN GASOLINE STERNDRIVES:

T-MerCruiser 6.2L MPI ECT* Bravo III w/DTS
(T-350 php - 261 kW)

*Non-catalyzed engines available for select international markets. Consult your local dealer for availability.

AXIUS® PROPULSION:

T-MerCruiser 6.2L MPI ECT* Bravo III w/Axius
(T-300 hp - 224 kW)

T-MerCruiser 6.2L MPI ECT* SeaCore® Bravo III w/Axius
(T-300 hp - 224 kW)

T-MerCruiser 6.2L MPI ECT* Bravo III w/Axius
(T-350 hp - 261 kW)

T-MerCruiser 6.2L MPI ECT* SeaCore® Bravo III w/Axius
(T-350 hp - 261 kW)

Axius Propulsion System Includes Axius Control Joystick,
SmartCraft Digital Throttle & Shift & SmartCraft
VesselView Display

*Non-catalyzed engines available for select international markets. Consult your local dealer for availability.

CANVAS OPTIONS

Toast Tweed or Blue Canvas (In Lieu of Black)

Cockpit Cover

Extended Aft Bimini

ELECTRONICS OPTIONS

Chartplotter/GPS - Raymarine® a95 (9" Color Widescreen)

Chartplotter/GPS/Radar - Raymarine a95

Note: Only One Chartplotter May Be Ordered

SmartCraft VesselView Display (Gas Engines Only):

- Active Alarms/Details
- Alarm History/Details
- Environment & Navigation: GPS Interface, Depth & Water Temperature, Depth Alerts, Trip Log Information, Fuel to Waypoint Data & Navigation Data
- Propulsion: Engine Hour Meters, Engine Status, Performance & Fuel, Peak Performance, Boost Pressure (Optional), Cruise Control, ECO-Screen, Smart Tow™ & Troll Control™
- Vessel: Vessel Status, Tank Status, Steering Position, Generator Data & Start/Stop

GENERATOR OPTIONS

5.0 kW Kohler® - Low Emission - Gas, 120V/60 Cycle

4.0 kW Kohler - Low Emission - Gas, 220V/50 Cycle (Int'l)

Includes Remote Start w/Muffler, Stainless-Steel Exhaust
Outlet, Closed Cooling, Remote Fuel Filter, Seacock &
Seawater Strainer

(Generator Manufacturer & Size May Vary Due to Product
Availability)

INDIVIDUAL OPTIONS

Air Conditioning/Heating, 120V/60 Cycle (12,000 BTU)

Bow Rail, Split

Bow Thruster (N/A w/Axius)

Bottom Paint (White Hulls Only)

Carpet Liner, Snap-In, Infinity Upgrade - Cockpit

Colored Hull, Full Hull (Onyx, Sea Ray Blue, Mahogany Brown
or Horizon Grey) Includes Bottom Paint

Digital Dash: Includes Raymarine a95 Chartplotter & Audio
Control Via Upgraded Fusion® 700 Series Stereo Head Unit

Digital Dash w/Radar; Includes Raymarine a95 Chartplotter
w/Radar & Audio Control Via Upgraded Fusion® 700 Series
Stereo Head Unit

Flagpole w/Base & US Flag

Flooring, Cockpit & Std Swim Platform - Teak

Flooring, Swim Platform Only - Teak

Flooring - For Opt Extended Swim Platform - Teak

Gel-Coated Dash

Gray Water System

Grill, Cockpit - Built-In (120V/60 Cycle)

Head, VacuFlush® w/Overboard Discharge (Int'l)

Inverter, 120V/12V

Lighting, Enhanced LED Package, - Cockpit

Lighting, Thru-Hull - Underwater

Macerator w/Seacock Interlock System

Refrigerator, Dual-Voltage, 120V/12V - Cockpit (In Lieu of
Standard Carry-On Cooler)

Rod Holders (4)

Seating, Foldaway, Aft-Facing - Transom

SiriusXM® Satellite Receiver w/Antenna (N/A Outside N.
America)

Spotlight, 5" Remote-Controlled

Stereo, Premium Cockpit Sound System w/Upgraded
Component Speakers, Amplifiers, Subwoofer & Transom
Stereo Remote

Stereo Remote Control - Additional Unit on Transom

Stove, 120V/60 Cycle - Alcohol/ Electric, Two Burner

Sun Pad w/Stainless Steel Deck Runners, Integrated iPod®

Speakers & Headrest - Forward Deck

Swim Platform - Extended

TV, Flatscreen & DVD Player, Dockside Inlet & Antenna -
Salon

TV, Flatscreen & DVD Player - Mid-Cabin (Only Available w/
Salon TV Option)

Windlass, All-Chain w/Foot Switches

Windlass, Rope/Chain w/Foot Switches

CE Option

*NOTE: Some features and options may not be available
when a boat is built for regions outside North America and/
or has CE Certification. Boats ordered with 220V/50 cycle
electrical systems will have the appropriate appliances in the
corresponding voltage.*

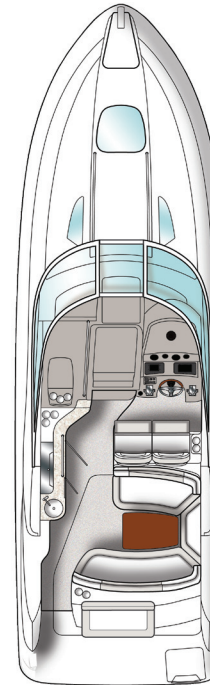

COCKPIT LAYOUT

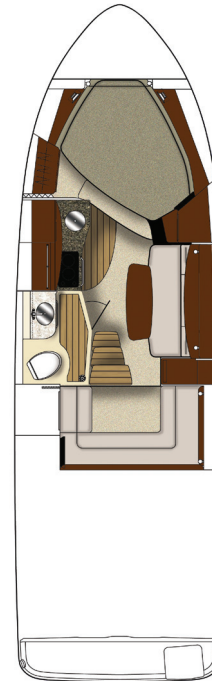

CABIN LAYOUT

330 SUNDANCER®

We spend our whole lives overbooked. Do more in your precious downtime with the 330 Sundancer. Take a longer weekend, extend your day of boating by a few golden hours. With a social cockpit zone, a comfortable cabin and a wide, easily accessible swim platform, your options for enjoyment abound. The 330 Sundancer is equipped to let you share the magic and peace of the water with as many people as you choose or just one special person for that romantic getaway.



The handsome control station includes a full complement of SmartCraft® diagnostic instrumentation, VHF radio, and room for a variety of electronic options.



From the deluxe galley with ample storage to the solid-surface counter tops and recessed stove, the 330 is a gourmand's dream. Now, cooking and entertaining on your boat is a piece of cake.



The cockpit features a solid-surface wet bar countertop with stainless-steel trim and can also accommodate a fridge and built-in grill, so your steaks are ready at a moment's notice.



The 330's extra-large extended hullside windows help bring the outside in, making the cabin airy and bright. Multi-tone accents and durable, marine-grade vinyl with UV-protection technology are more than just finishing touches on the 330.



The luxurious, wood-trimmed double V-berth includes a roomy storage cabinet with shelves and a convenient hanging locker.



08262015